



भारतीय राष्ट्रीय राजमार्ग प्राधिकरण
(सड़क परिवहन और राजमार्ग मंत्रालय, भारत सरकार)
NATIONAL HIGHWAYS AUTHORITY OF INDIA

(Ministry of Road Transport & Highways, Government of India)

क्षेत्रीय कार्यालय - हैदराबाद

प्रथम तल, नया भवन, भारतीय प्रशासनिक स्टाफ कॉलेज, रोड नं-3, बंजारा हिल्स, हैदराबाद-500 034, तेलंगाना.

REGIONAL OFFICE - HYDERABAD

First Floor, New Building, Administrative Staff College of India (ASCI), Road No. 3, Banjara Hills, Hyderabad - 500 034, Telangana.

टेली / Tele : 040 - 29562147 / 48 ई-मेल / Email : rohyderabad@nhai.org, nhairohyd@gmail.com

Notice Inviting Public Comments

NHAI/RO-HYD/25011/1/43/2022/Utility/1070

Dt.20.07.2022

Sub: NHAI - RO Hyderabad - PIU Hyderabad- Proposal for crossing of 220 KV DC LILO lines between Km.73+600 to Km. 73+800 at 61 degree skew near Peddakaparthi , across Hyderabad to Vijayawada section of NH-65 in the State of Telangana- Reg..

Ref: 1. PIU Hyd Lr.no. NHAI/PIU-HYD/NH-65/Hyd-Vij/TS TRANSCO/2022/1078,dt:11.07.2022

The Project Director, PIU, NHAI Hyderabad vide letter cited above has recommended the Proposal of Executive Engineer, TS TRANSCO, Nalgonda for crossing of 220 KV DC LILO lines between Km.73+600 to Km. 73+800 at 61 degree skew near Peddakaparthi , across Hyderabad to Vijayawada section of NH-65 in the State of Telangana.

2. As per para 4 of the Ministry's guidelines no. RW/NH-33044/29/2015/S&R(R) dated 22.11.2016, public comments is hereby invited on the above proposal seeking claims and objections (on grounds of public inconvenience, safety and general public interest) within 30 days on public portal i.e. website of Ministry of Road Transport and Highways (www.morth.nic.in) in Form-A (copy enclosed) for "Accommodation of Public and Industrial Utility Services along and across National Highways".

Comment Inviting Authority

The Regional Officer,
National Highways Authority of India,
Regional Office: Hyderabad,
First Floor, New Building,
Administrative Staff College of India(ASCI),
College Park Campus, Road No.3,
Banjara Hills, Hyderabad - 500 034,
Telangana State,
Phone: 040-29562147, 040-29562148,
Email: rohyderabad@nhai.org, nhairohyd@gmail.com

Encls: Above Proposal

Yours faithfully,

(V. Nagamani)

Dy General Manager (Tech)

For Regional Officer-cum-

Highway Administrator, Hyderabad

To:

1. Senior Technical Director, NIC, Transport Bhawan, New Delhi- 110001 for uploading on Ministry's website.
2. Shri S.Manivasagam, Dy. GM (IT), NHAI HQs, New Delhi for uploading on NHAI website.

Copy to:-1. The Project Director, NHAI, PIU Hyderabad: for information

FORM-A

Form for seeking claims and objections (on grounds of public inconvenience, safety and general public interest) on the application for Accommodation of Public and Industrial Utility Services along and across National Highways

Sub: NHAI - RO Hyderabad - PIU Hyderabad- Proposal for crossing of 220 KV DC LILO lines between Km.73+600 to Km. 73+800 at 61 degree skew near Peddakaparthi , across Hyderabad to Vijayawada section of NH-65 in the State of Telangana -Reg.

The claims and objections (on grounds of public inconvenience, safety and general public interest) by the general public needs to be given within 30 days of uploading the online application for comments

Sl. No	Item	Details
1	Name of the person who is desiring to give claims and objections (on grounds of public inconvenience, safety and general public interest)	
2	Address of the person	
3	Details of the application for Accommodation of Public and Industrial Utility Services along and across National Highways against which claims and objections are being given (name of applicant and other details like site address etc.)	
	a) Application No.	
	b) Name of applicant (who applied to Accommodation of Public and Industrial Utility Services along and across National Highways)	
	c) Details of Application	
4	The claims and objections (on grounds of public inconvenience, safety and general public interest)	

DETAILS OF POWER LINE CROSSING ON NATIONAL HIGHWAY-65

Sl. No.	Description of Work	Information	Remarks
1.	Nature of Work	Erection, Testing & Commissioning 220 KV DC LILO (15.5Km) of existing 220KV Malkaram – Narketpally DC line to proposed 400/220/132KV SS Choutuppal on multi circuit towers in Yadadri - Bhongiri District	
2.	Name and Address of Applicant	G. Venkateshwarlu, Executive Engineer/Construction Division, TS TRANSCO/Nalgonda.	
3.	National Highway No. and Section	NH-65, Hyderabad – Vijayawada Section	
4.	Crossing Chainage	Between 73+600 & 73+800	
5.	Width of available ROW		
a)	Location of left side tower from centre line of NH while facing towards Hyderabad	75 mtrs	
b)	Location of right-side tower from centre line of NH while facing towards Hyderabad	95 mtrs	
c)	Span between Towers	170 mtrs	
6.	Vertical clearance from lowest power line conductor to centre of road level	14.215mtrs	
7.	Electrical Clearance for 132 kV Overhead line crossing National Highway as per IS 5613 and IER-1956 Height of Towers	12.5mtrs	
8.	Height of Towers	NMD+6 (54.8mtrs) & NMD+6(54.8mtrs)	

Executive Engineer
Construction, Nalgonda
TS TRANSCO
(SE)

Asst. Executive Engineer
Construction, Sub-Division
TS TRANSCO, Nalgonda
mgr (T)

Assistant Engineer
Construction, TS Transco
PROJECT DIRECTOR
NATIONAL HIGHWAYS AUTHORITY OF INDIA
PROJECT IMPLEMENTATION UNIT
HYDERABAD - 500 034

COMPLIANCE/REQUIREMENT OF HT LINE CROSSING-NHAI

Sl.No.	Description	Compliance Yes/No
1	a) Exact chainage of the location of power line crossing NH-65 near Peddakaparthi(V),Chityal(M)shall be furnished in the drawings.	Chainage furnished in the drawing
	b) Drawing containg the relevant details like grade of concrete/ Details of reinforcement, dimensions for foundation.	Drawings Furnished
2	The adequacy of design of all the components of various structuresshall bc ensured by TSTRANSCO	Will be ensured
3	No Part of the foundation of electrical tower shall in ROW of NHAI	Will be ensured
4	Minimum vertical clearance of the overhead electrical line forcrossing the national highway shall be in accordance with the guidelines as mentioned in the central Electrical Authority Regulations/Statutory provisions of Indian Electrical Rules.	Yes
5	The work executing department i.e., M/s Deepak Galvanising & Engineering Industries Private Ltd JV with M/s Bindu Constructions, Nacharam, Hyderabad shall be conveyed to the follow of IRC:32 1969, Central Electrical Authority Regulations/Statutory provisions of India Electricals Rules and other relevant guidelines issued on the above subject matter by NHAI, MORTH.	Yes
6	A copy of the work program, particularly for the work related to the crossing NH-65 near Peddakaparthi(V) shall be provided to NHAI well inadavance. The changes in the given work program if any, shall be provided to the NHAI well in advance	Yes
7	List and contact number of responsible engineers of above agency, available at sitc shall also be provided to NHAI for coordination at site level.	Yes
8	All the necessary safety arrangements shall be taken by the concerned department, i.e., TSTRANSCO for carry out the works referred under the subject matter.	Yes
9	In case if any lane closure is required for carrying such works necessary permission shall be obtained well in advance from NHAI authorities for smooth and uninterrupted flow of traffic along the National Highway.	Yes
10	The arrangements proposed by the department, for the safety. protection, structural stability and required under taking shall be submitted by the above department alone with the application and the same shall be adhered to and implemented	Yes
11	As stated in the under taking submitted by TSTRANSCO they have to commence the work after obtaining approval from the NHAI	Yes

She
(S.E)

PROJECT DIRECTOR
NATIONAL HIGHWAY AUTHORITY OF INDIA
P.D
MENTATION UNIT
AD - 500 034

Executive Engineer
Construction, Sub-Division
TSTRANSCO, Nalgonda

Asst. Executive Engineer
Construction, Sub-Division
TSTRANSCO, Nalgonda

Assistant Engineer
Construction, TSTRANSCO
Suryanet

Name of the work : Erection of 220 KV DC LILO (15.5Km) of existing 220KV Malkaram - Narketpally DC line to proposed 400/220/132KV SS Choutuppal on multi circuit towers on turnkey basis in Yadadri - Bhongiri District

TOWER SCHEDULE

Sl. No.	Loc. No.	Type of Tower	Angle of Deviation	Span in Mtrs.	Weight of Spans			Remarks
					Left	Right	Total	
1	7/4	Y+6	00°		184	117	301	
				250				
2	8/0	NMD+6 (1.25Meter STUB EXTENSION)	15°(RT)		133	90	223	AP No. 8
				170				Span 8/0 - 9/0 : NH 65 Xing clearance 14.215M. 33 KV, 11KV Line X ing clearance 11.387M, 11.999M.
3	9/0	NMD+6 (1.25Meter STUB EXTENSION)	36°(LT)		80	128	208	AP No. 9
				250				
4	9/1	Y+3	00°		122	145	267	

Executive Engineer
Construction, Nalgonda
TSTRANSCO

Asst. Executive Engineer
Construction, Sub-Division
TSTRANSCO, Nalgonda



Assistant Engineer
Construction, TSTRANSCO
Suryanet

mgh(T)

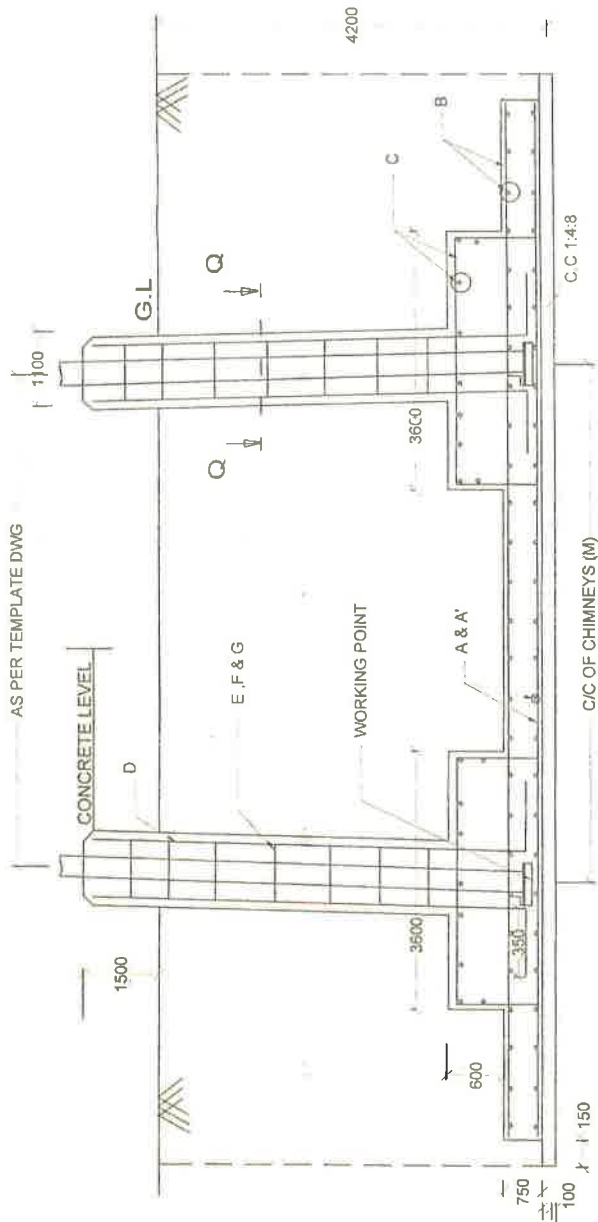

(S.E)

PROJECT DIRECTOR
NATIONAL HIGHWAY AUTHORITY OF INDIA
PROJECT IMPLEMENTATION UNIT
HYDERABAD - 500 034.

AS PER TEMPLATE DWG

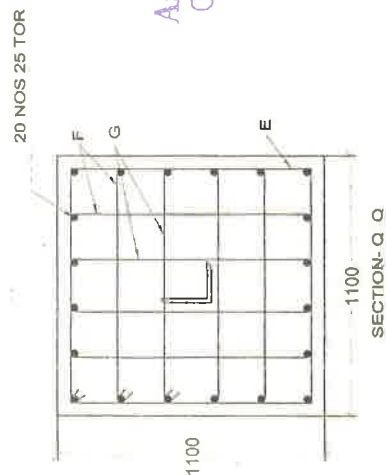

*** THE STUB SECTION, STUB LENGTH, C/C DISTANCE OF PEDASTALS SHALL BE VERIFIED W.R.T APPROVED TEMPLATE DRAWING BEFORE STARTING EXECUTION







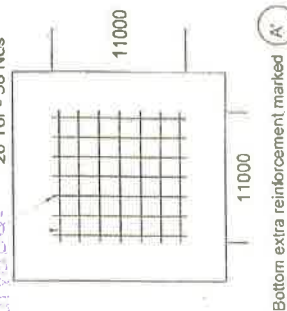



Asst. Executive Engineer
Construction, Sub-Division
TSTRANSCO, Nalgonda

Assistant Engineer
Construction, ISFRSCO
17500
Bottom reinforcement marked A
Bars marked A'
20 Tor - 56 Ncs
Surveyor



Executive Engineer
Construction, Nalgonda
TSTRANSCO

Bottom extra reinforcement marked

STATEMENT OF REINFORCEMENT BARS						
BAR MARK	SHAPE & SIZE (MM)	DIA (MM)	UNIT WT KG/RM	LENGTH METER	NOS/TWR	WT/TWR KG
A		20	2.47	17.4	83x2	7850.084
A'		20	2.47	11.0	55x2	3043.04
B		16	1.58	17.4	134x2	5718.336
C		20	2.47	6.1	23x2x4	2772.328
D		25	3.85	5.83	22x4	1795.64
E		8	0.395	4.15	28x4	183.596
F		8	0.395	3.37	28x2x4	298.177
G		8	0.395	2.59	28x2x4	229.163

TOTAL = 21690 364 KG

APPROVED & RELEASED

Lamelle 26/08/11
Chief Engineer / CIVIL (E/C)
ISTRANSCO. V.S., H-90-92

TRANSMISSION CORPORATION OF TELANGANA LIMITED

220 KV DC LILO FROM EXISTING 220 KV MALKARAM- NARKETPALLY DC LINE
TO PROPOSED 400/220/132KV SS CHOUTUPPAL (MC TOWERS) IN YADADRI
SHONGIRI DISTRICT

FOUNDATION DETAILS OF M/C 220 KV (NMD+5) WITH 1.5 M STUB EXTENSION TOWER (FS/WBC CLASSIFICATION)

SCALE: N.T.S.

HYDERABAD - VIJAYAWADA NATIONAL HIGHWAY NO - 65 (NH-65) CROSSING BETWEEN KM NO'S : 73/6 & 73/8 OF PROPOSALS FOR ERECTION, TEST & COMMISSIONING OF 220 KV DC LIL0 (15.5km) OF EXISTING 220 KV MALKARAM - NARKETPALY DC LINE TO PROPOSED 400/220/132 KV.S.S. CHOUTUPPAL ON MULTI CIRCUIT TOWERS IN YADADRI - BHONGIR DISTRICT

LOC NO 8/0

LOC NO 9/0

(NMD+6) BETWEEN HYDERABAD - VIJAYAWADA NATIONAL HIGHWAY CROSSING

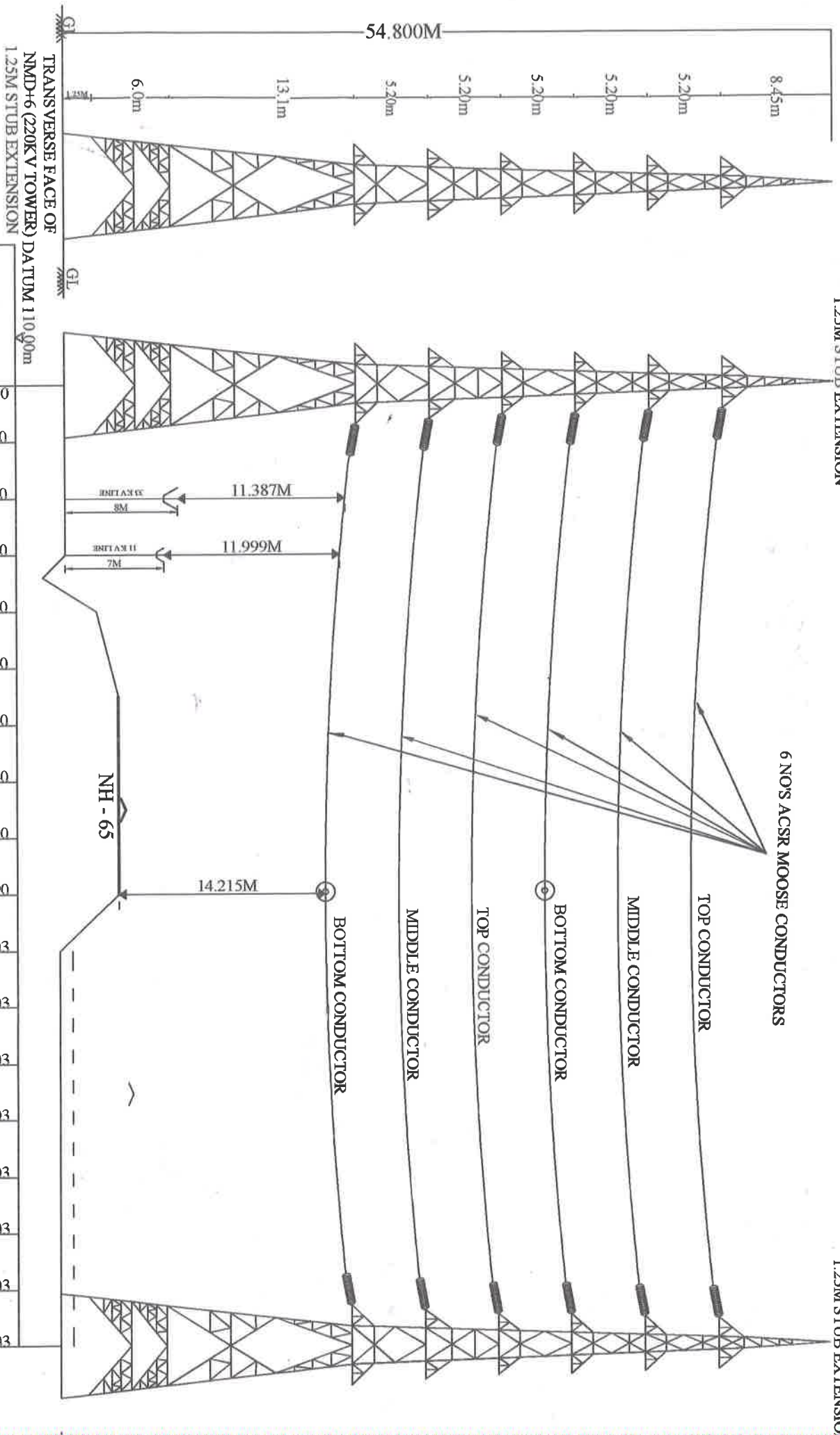

LEVELS	DISTANCE IN METERS	000	10	20	30	40	50	60	70	80	90	100	110	120	130	140	150	160	170
		113.480	113.480	113.480	113.470	115.690	116.690	117.190	117.190	117.190	117.190	113.003	113.003	113.003	113.003	113.003	113.003	113.003	113.003

HYDERABAD

LOC NO. 8/0
(220KV NMD+6 TOWER)
15°(RT)

LOC NO. 9/0
(220KV NMD+6 TOWER)
36°(LT)

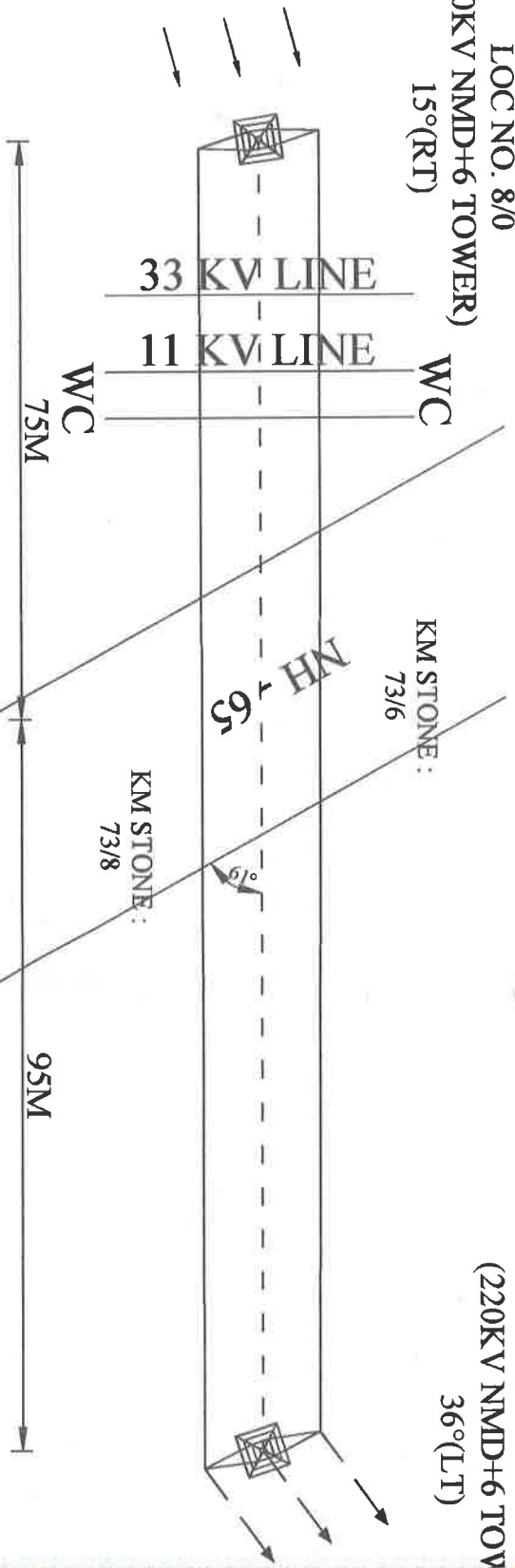

FOUNDATION DETAILS OF M/C 220 KV (NMD+6) TYPE TOWER (FS)

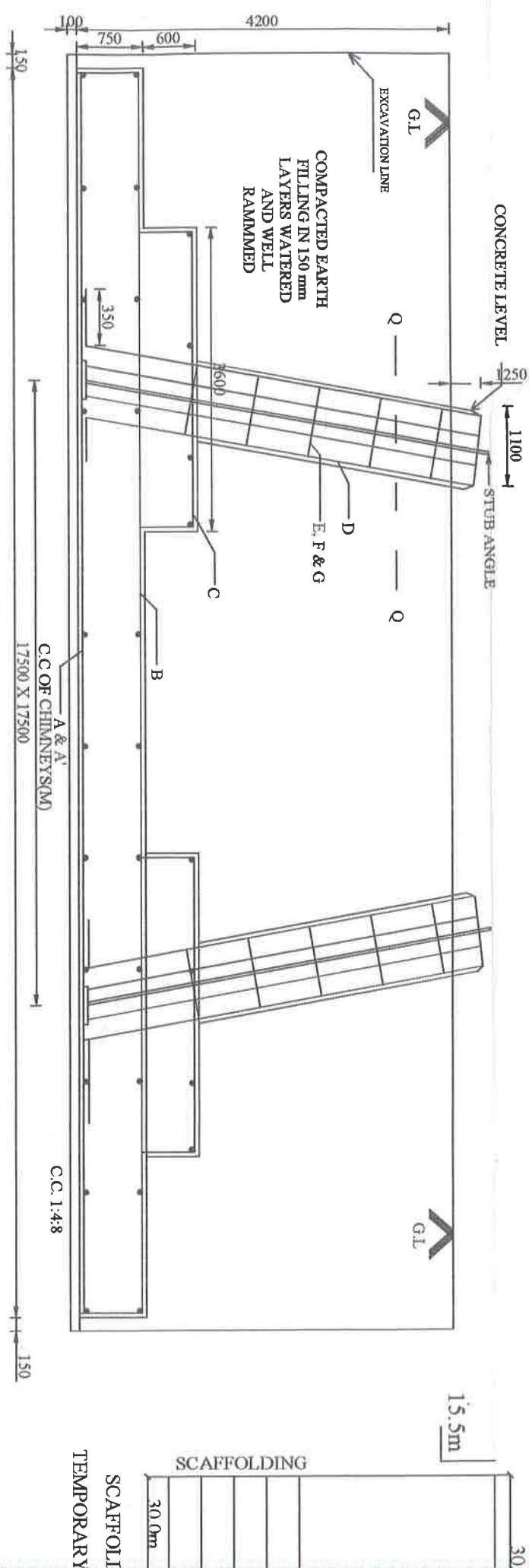

QUANTITIES

EXCAVATION	= 1330.728CUM
CONCRETE RCC M20	= 281.845CUM
CONCRETE 1:4:8	= 31.680CUM
R/F STEEL KG	= 21690.364



DANGER PLATE

TITLE DETAILS OF DANGER PLATE

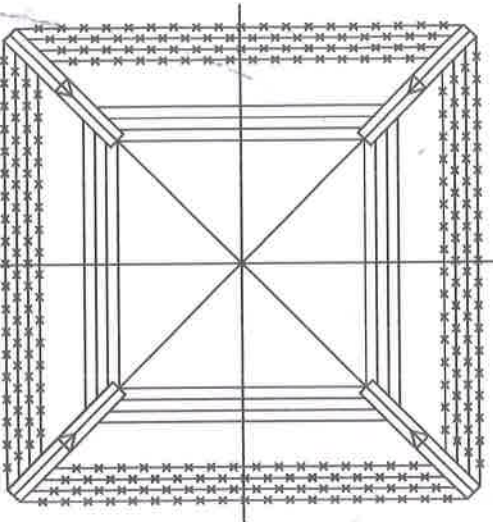
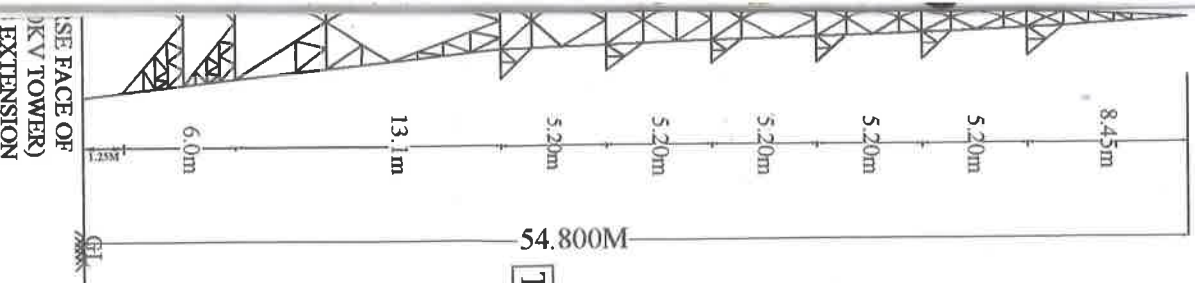

PLAN DETAIL OF ANTICLIMBING DVICE

BAR BENDING SCHEDULE FOR FOUNDATION

BAR TYPE	SKETCH	DIA (MM)	LENGTH (M)	NOS/ TOWER	WEIGHT (Kg/m)	WEIGHT PER TOWER (Kgm)
A'	11000	20	11.0	56X2	2.47	3043.04
A	17400	20	17.4	89X2	2.47	7650.084
B	17400	16	17.4	104X2	1.58	5718.336
C	1300 3500	20	6.1	23X2X4	2.47	2772.328
D	350 5480	25	5.83	20X4	3.853	1795.64
E	10005	8	4.15	28X4	0.395	183.596
F	1000	8	3.37	28X2X4	0.395	298.177
G	1000 220	8	2.59	28X2X4	0.395	229.163
				TOTAL WEIGHT (Kgs) = 21690.364		

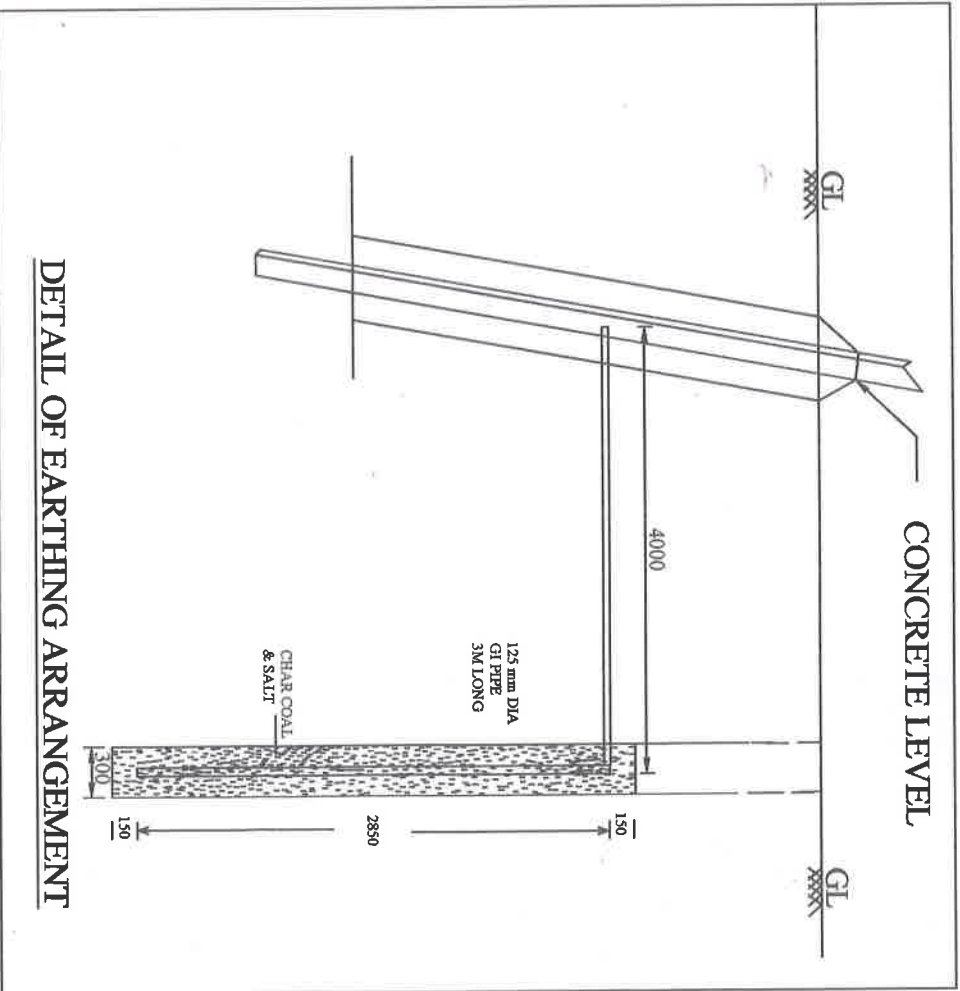

CLIENT : TRANSMISSION CORPORATION OF TELANGANA LIMITED

NAME OF THE WORK : ERECTION, TESTING & COMMISSIONING OF 220 KV DC LIL O (15.5KM) OF EXISTING 220 KV MALKARAM - NARKETPALY DC LINE TO PROPOSED 400/220/132 KV.S.S. CHOUTUPPAL ON MULTI CIRCUIT TOWERS IN YADADRI - BHONGIR DISTRICT

KM NO'S : 73/6 & 73/8

LINE - IN

REFERENCE OF OVERHEAD NATIONAL HIGHWAY - 65 CROSSING DATA

1. PROPOSED NATIONAL HIGHWAY CROSSING
2. CROSSING ANGLE = 61°
3. CROSSING SPAN = 170 M
4. CROSSING ANGLE OF DEVIATION LOC NO 8/0 = 15°(RT) & LOC NO 9/0 = 36°(LT)
5. CROSSING TOWER TYPE IS (I) LOC NO 8/0 : (NMD+6) (II) LOC NO 9/0 : (NMD+6)
6. CLEARANCE NATIONAL HIGHWAY TOP AND LOWEST LINE CONDUCTOR = 14.215M
7. HEIGHT OF TRANSMISSION LINE/TOWER = LOC NO 8/0 & 9/0 = 54.800M

Executive Engineer
Construction, Nalgonda
TSTRANSCO

Asst. Executive Engineer
Construction, Sub-Division
TSTRANSCO, Nalgonda

Assistant Engineer
Construction, TSTRANSCO
Survapet